



KM-ICD-71SD-FG

70 in. 12 Tub Ice Cream Dipping Cabinet Display Freezer with Sliding Glass Door and Sneeze Guard



Features:

- Interior LED lighting
- Front-facing temperature control
- Rolling caster wheels makes it easier to move for cleaning or repositioning
- Ergonomic handle on the side
- Eco-friendly R-290 Refrigerant
- Plug Type: 5-15P, Hz: 60, Voltage: 115

Dimensions

- Overall dimensions 70.86 "W x 28.1" D x 52" H

Certification

- ETL Listed for Safety and Sanitation NSF compliant

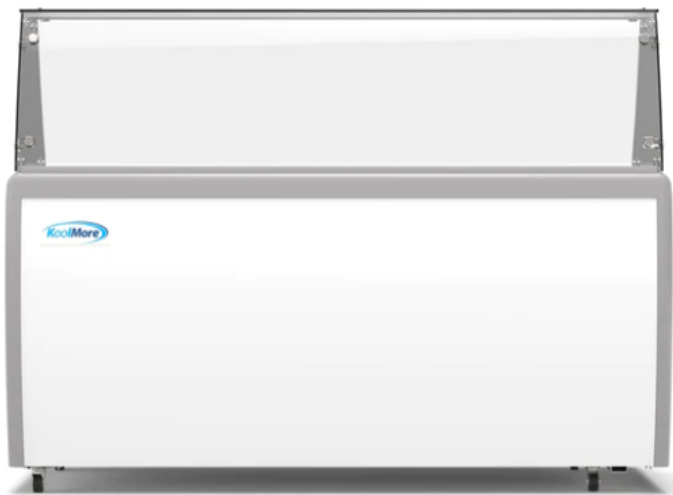

Parts & Labor
NSF-7 Standards





Dimensions:

Product Depth (in.)	28.1	Product Height (in.)	52
Product Width (in.)	70.86	Capacity (cu. Ft.)	20
Product Weight (lbs.)	286	Packaging Dimensions (in.)	70.86x28.1x52

Electrical:

Rated Voltage	115 V	Rated Frequency	60 Hz
Rated Current	4 A	Refrigerant	R290
Plug Type	5-15P	Horse power	2/5

Cooling:

Temperature Range	-15°F and 10°F	Refrigerant	R290
Defrosting	Manual	Temperature Controller	Electro-mechanical

Specifications:

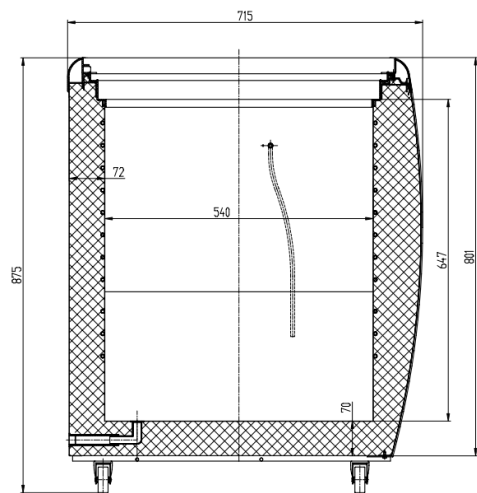
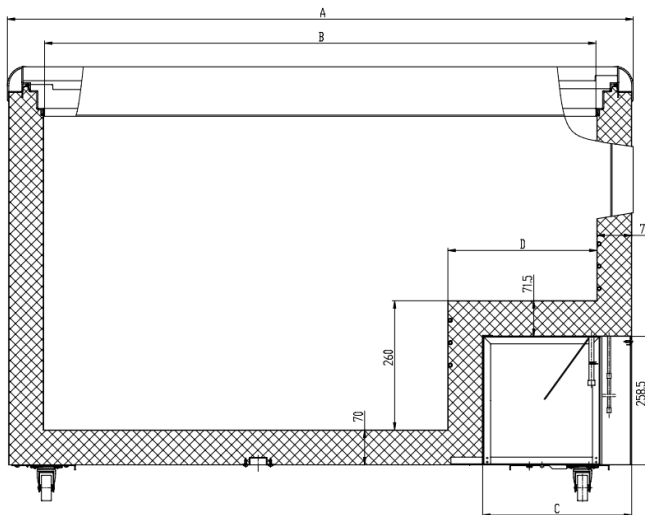

Model No.	A	B	C	D
RI-160	665	515	270	250
RI-260	990	840	300	300
RI-360	1260	1110	300	300
RI-460	1530	1380	300	300
RI-560	1800	1650	300	300